

# XAPR

## Pressure-fed/Int. Mix/Narrow Angle Round

### DESIGN/SPRAY CHARACTERISTICS

- Internal mix
- Very fine atomization
- Narrow spray angle (12° - 22°)
- Full cone pattern
- Large forward projection (up to 8.5 m)

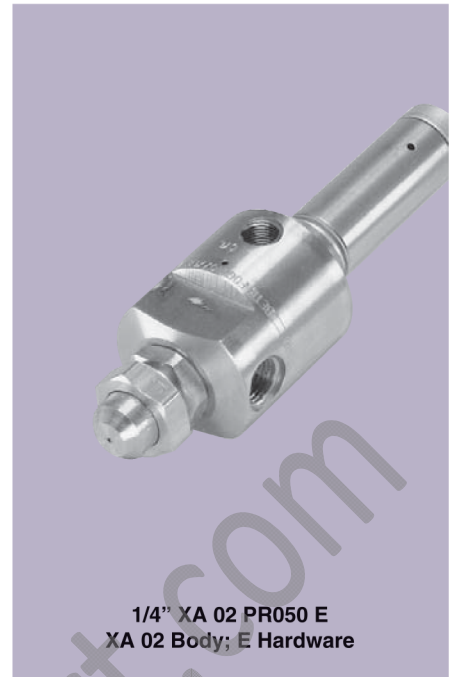
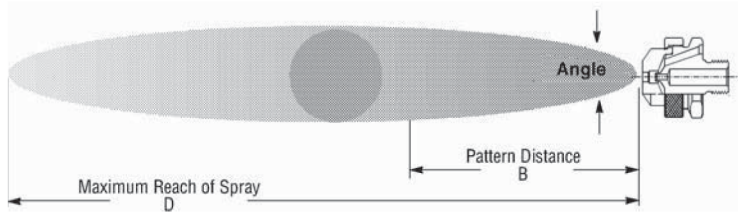

Dimensions are approximate. Check with BETE for critical dimension applications.

### XA PR Set-up Flow Rates and Dimensions

Pressure-fed, Internal Mix, Round Spray Pattern, 1/8" and 1/4" Pipe Sizes, BSP or NPT

Pipe Size	Spray Set-up Number	Fluid and Air Cap Numbers	0.7 Bar Liquid			1.5 Bar Liquid			2.0 Bar Liquid			3.0 Bar Liquid			4.0 Bar Liquid			Spray Dimensions						
			Air (bar)	l/h	Nm <sup>3</sup> /h	Air (bar)	l/h	Nm <sup>3</sup> /h	Air (bar)	l/h	Nm <sup>3</sup> /h	Air (bar)	l/h	Nm <sup>3</sup> /h	Air (bar)	l/h	Nm <sup>3</sup> /h	air	Bar liquid	Spray Angle (deg.)	B (mm)	D (m)		
1/8 OR 1/4	PR 050	Fluid Cap FC4 & Air Cap AC1501	0.7	2.5	0.960	1.1	6.4	0.720	1.4	6.4	0.840	2.7	6.2	1.38	3.5	7.8	1.68	0.9	0.7	13	300	3		
			0.9	1.8	1.14	1.4	5.0	0.900	1.7	5.5	1.02	2.8	5.7	1.50	3.7	7.3	1.74							
			1.0	1.4	1.32	1.7	4.1	1.14	2.0	4.5	1.20	3.0	5.2	1.62	3.9	6.4	1.98							
			1.8	3.4	1.20	2.2	3.4	1.44	3.1	4.7	1.74	4.2	5.5	2.28	4.5	5.5	2.58							
			2.0	3.0	1.38	2.4	3.0	1.56	3.2	4.3	1.86	4.5	4.5	2.58	3.1	3.0	14						390	4
			2.1	2.6	1.50	2.5	2.5	1.68	3.4	3.9	1.98	4.6	4.1	2.70	4.5	4.0	15						440	4
	2.2	2.0	1.62	2.7	2.3	1.86	3.7	3.0	2.28	4.8	3.7	2.82	4.8	3.7	2.82									
	PR 100	Fluid Cap FC4 & Air Cap AC1502	0.7	2.5	1.14	1.4	5.7	1.62	1.7	6.7	1.74	2.2	9.2	2.04	2.8	11.9	2.34	0.9	0.7	12	430	4		
			0.9	2.0	1.32	1.5	5.2	1.74	1.8	6.4	1.86	2.5	8.2	2.34	3.1	11.0	2.58							
			1.0	1.6	1.56	1.7	4.8	1.92	2.0	5.9	2.04	2.8	7.2	2.64	3.4	10.1	2.82							
			1.8	4.3	2.10	2.1	5.2	2.22	3.0	6.7	2.82	3.7	9.2	3.12	4.2	9.2	3.12							
			2.0	3.9	2.22	2.2	4.8	2.40	3.1	6.3	2.94	3.9	8.4	3.48	3.0	3.0	13						510	5
2.1			3.4	2.40	2.4	4.3	2.58	3.2	5.9	3.12	4.2	7.6	3.72	3.9	4.0	15	560						5	
2.7	3.6	2.88	3.4	3.6	3.00	4.2	3.6	3.30	4.5	6.8	4.08	4.5	6.8	4.08										
PR 150	Fluid Cap FC3 & Air Cap AC1502	0.9	4.8	1.26	1.7	8.4	1.86	2.0	10.7	1.98	2.7	16.5	2.22	3.4	20.0	2.58	1.5	0.7	12	480	4			
		1.1	4.1	1.62	1.8	7.5	2.10	2.1	9.8	2.22	2.8	15.4	2.28	3.7	18.4	2.82								
		1.4	3.4	1.98	2.0	7.0	2.22	2.4	8.2	2.52	3.1	13.6	2.58	3.9	16.8	3.00								
		1.5	3.1	2.10	2.2	5.7	2.64	2.7	6.8	2.88	3.4	11.8	2.94	4.2	15.2	3.30								
		1.7	3.0	2.34	2.5	4.8	2.94	3.0	5.9	3.30	3.7	10.4	3.30	4.5	13.8	3.60								
		1.8	2.9	2.46	2.8	4.1	3.24	3.2	5.0	3.54	3.9	9.1	3.66	4.8	12.4	3.90								
2.0	2.8	2.64	3.1	3.6	3.54	3.5	4.1	3.90	4.2	7.9	3.90	4.9	11.8	4.08	4.2	4.0	15	600	5					
PR 200	Fluid Cap FC2 & Air Cap AC1503	1.1	13.0	4.56	2.2	17.8	6.96	2.8	20.0	8.16	3.4	32.0	8.94	4.6	37.0	11.6	1.7	0.7	18	660	5			
		1.4	8.9	5.46	2.5	13.1	7.80	3.1	16.3	8.94	3.9	25.0	10.2	5.3	29.0	13.2								
		1.5	7.2	5.88	2.8	9.5	8.58	3.4	11.9	9.78	4.6	15.9	12.3	5.6	25.0	14.1								
		1.7	5.8	6.30	3.1	7.0	9.42	3.9	7.0	11.2	5.3	9.1	14.4	6.0	21.0	15.0								
		1.8	4.7	6.72	3.4	4.9	10.3	4.2	4.7	12.3	5.6	6.8	15.3	6.3	17.4	16.2								
		2.0	3.6	7.14	3.5	4.2	10.7	4.6	3.0	13.2	6.0	5.0	16.5	6.7	14.0	17.4								
2.1	2.7	7.62							6.3	3.6	17.4	7.0	11.0	18.3		6.0	4.0	21	970	9				
PR 250	Fluid Cap FC1 & Air Cap AC1503	0.9	31.0	3.42	1.4	61.0	4.14	2.1	53.0	5.76	2.7	80.0	6.18	3.8	88.0	8.10	1.0	0.7	17	610	5			
		1.0	25.0	3.96	1.5	54.0	4.56	2.4	41.0	6.72	3.0	69.0	7.02	4.2	73.0	9.36								
		1.1	18.5	4.50	1.7	48.0	5.10	2.7	31.0	7.62	3.2	59.0	7.80	4.6	61.0	10.6								
		1.3	12.9	5.10	1.8	41.0	5.58	2.8	26.0	8.16	3.5	49.0	8.76	4.9	48.0	11.8								
		2.0	35.0	6.12	3.0	35.0	6.12	3.0	22.0	8.64	3.7	44.0	9.24	5.3	39.0	12.9								
		2.1	30.0	6.60	2.1	30.0	6.60	2.1	22.0	8.64	3.8	37.0	9.66	5.6	31.0	14.4								
2.2	25.0	7.14	2.2	25.0	7.14	2.2	22.0	8.64	3.9	35.0	10.2	6.0	23.0	15.6	4.9	4.0	21	910	9					
PR 300	Fluid Cap FC5 & Air Cap AC1504	1.0	44.0	5.16	1.4	125	4.74	2.0	123	6.48	2.2	199	5.28	3.0	250	5.94	1.0	0.7	19	890	6			
		1.1	32.0	6.12	1.5	106	5.46	2.1	108	7.14	2.5	174	6.60	3.2	225	7.20								
					1.7	87.0	6.30	2.2	95.0	7.80	2.8	146	7.98	3.5	205	8.46								
					1.8	70.0	7.08	2.4	79.0	8.58	3.1	121	9.24	3.8	182	9.78								
					2.0	55.0	7.80	2.5	64.0	9.30	3.2	108	9.96	4.1	159	11.0								
					2.7	52.0	9.96	3.4	52.0	9.96	3.4	95.0	10.6	4.6	121	13.5								
			2.8	42.0	10.7	2.8	42.0	10.7	3.5	84.0	11.2	4.9	93.0	15.3	3.8	4.0	22	1170	9					

Standard Materials: Nickel-plated Brass, 303 Stainless Steel, and 316 Stainless Steel

AIR ATOMIZING